

SFT-2000

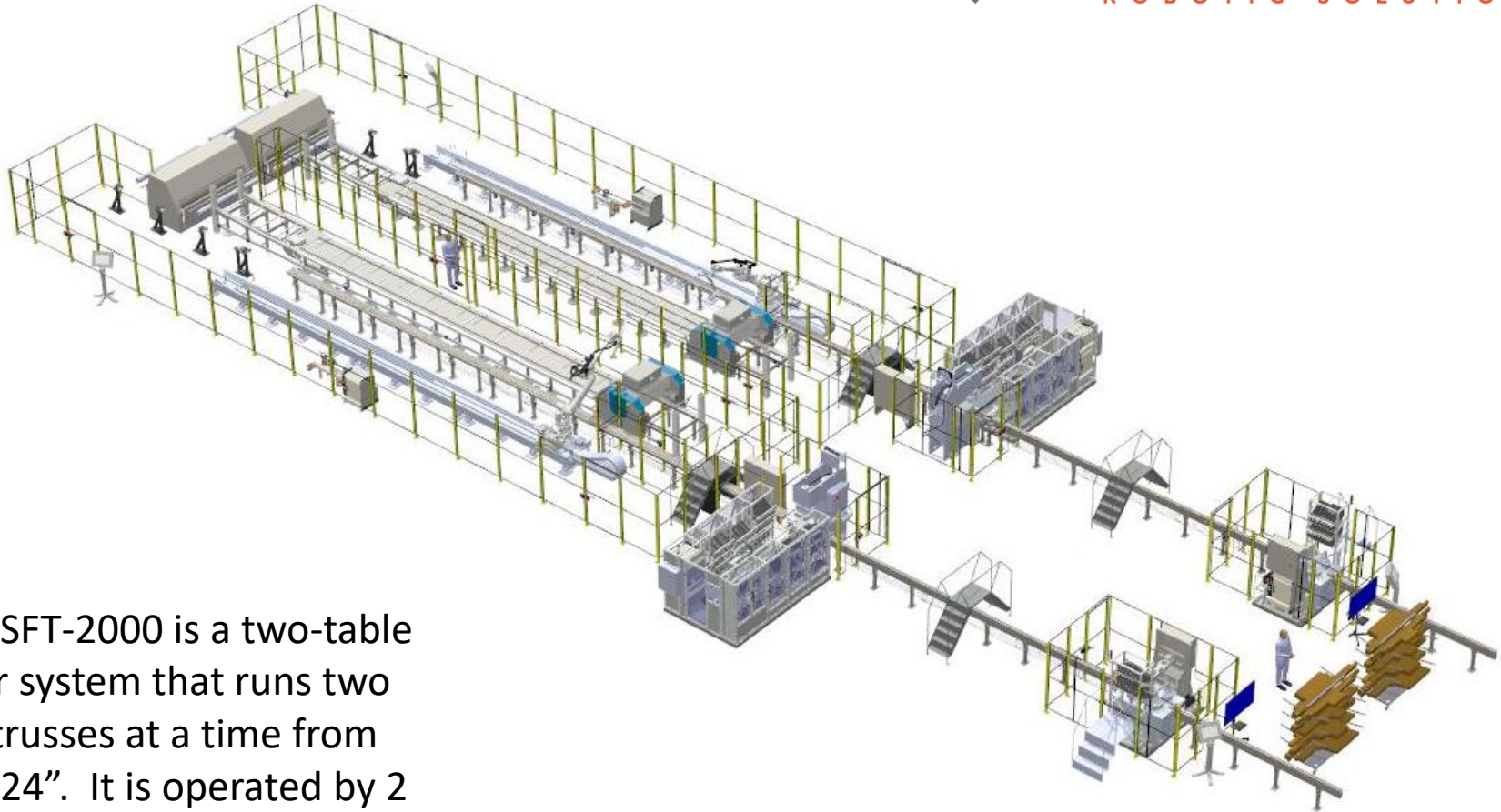

The SFT-2000 is a two-table floor system that runs two 40' trusses at a time from 12"-24". It is operated by 2 employees

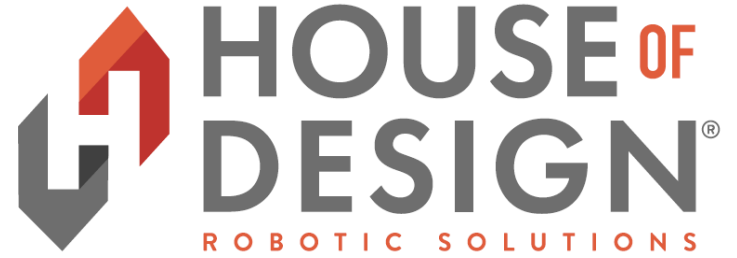
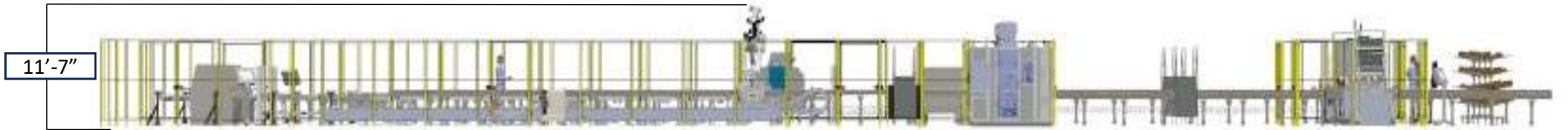
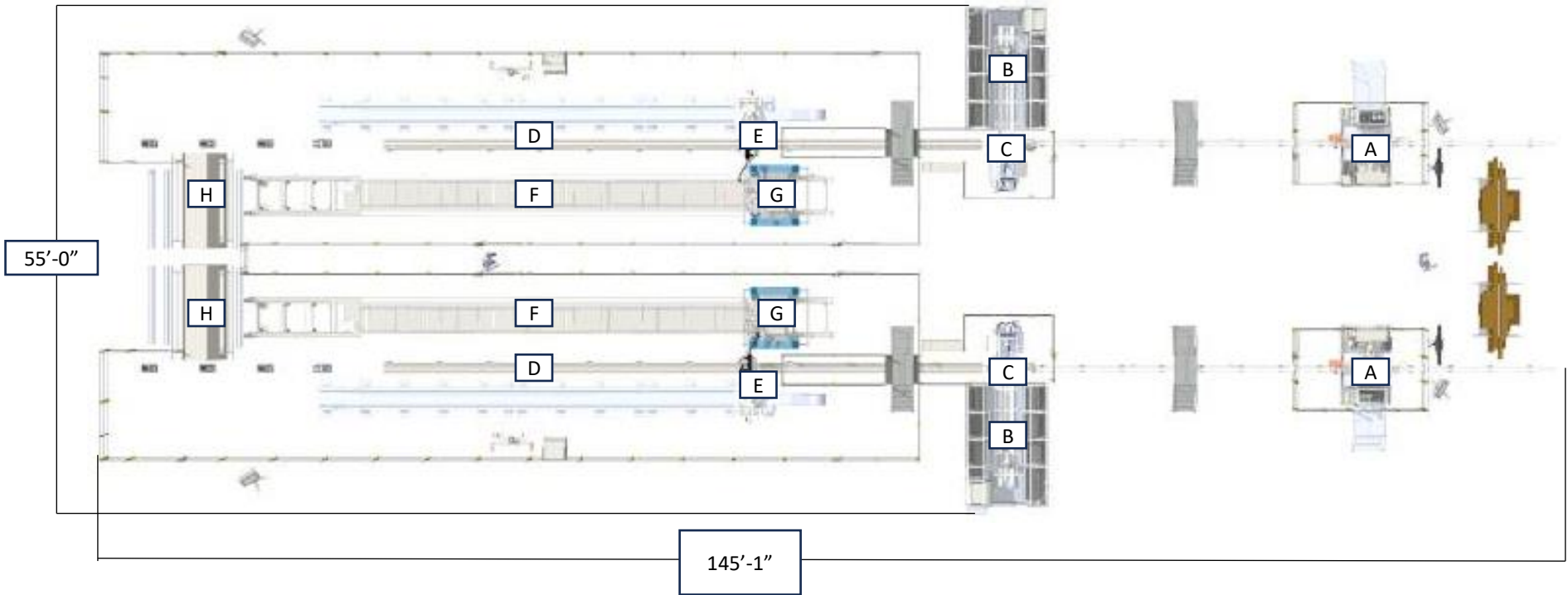

Area	Part	Qty	Description
Splicer	A	2	Automated Splicer with Robot
Pre-Plate	B	2	Nail plate System with 65 Magazines
	C	2	Nail Plate Press
Assembly Area	D	2	Wood Transfer Conveyor
	E	2	Robot With End of Arm Tool on Track
	F	2	40' Automated Table
	G	2	Table Gantry
	H	2	Finish Roller